



# BEARING & TOOL CENTRE



## Head Office

1<sup>st</sup> Floor, Vyapar Bhavan, Kadia Kui,  
Relief Road, Ahmedabad - 380001.  
Ph:- 079 - 22160386, 65254835, 22134835  
Mobile : 7819819941, 9375706649

## Ahmedabad Branch

GF-B-14, Jayraj Complex, Nr. Soni ni Chawl,  
Odhav, Ahmedabad - 382415.  
Ph:- 079 - 22890202, 65458950, 65404657, 65400202  
Mobile : 7878825197, 7819819938, 9375706648

Website : [www.bearingtoolcentre.com](http://www.bearingtoolcentre.com), [www.bearingtoolscentre.com](http://www.bearingtoolscentre.com) | Email : [info@bearingtoolcentre.com](mailto:info@bearingtoolcentre.com)

## Our Sister Concern : RELIEF SERVICE CENTRE

Repairs, Removal of Jaw Error, Bore Gauge Extension, Instrument Modifications & Spares

### Quotation

#### 60 | Radius Gauge

Range-mm	W	C	D%	Radius 1 - 7	Ra 7.5 - 15	Ra 15.5 - 25	Ra 25 - 40	Ra 0.4 - 6	Ra 0.5 - 13
Insize Rs.	12	N		732	728	739			2375
Code				<b>4801-17</b>	<b>4801-16</b>	<b>4801-15</b>			<b>4804-26</b>
Catalog				Page No.- 3	Page No.- 3	Page No.- 3			Page No.- 4
Kristeel Rs.	12	N	30	245	270	280	375		2100
Code				<b>1512 - A</b>	<b>1512 - B</b>	<b>1512 - C</b>	<b>1512 - D</b>		<b>1512 - 26L</b>
Catalog				Page No.- 6	Page No.- 6	Page No.- 6			Page No.- 8
Aerospace Rs.		N	10	120	150	150			1340
M & W Rs.	6	N		350	450	550			1800
Code				<b>RGS 13</b>	<b>RG 7</b>	<b>RG 15</b>	<b>RG 25</b>		
Catalog				Page No.- 9	Page No.- 9	Page No.- 9	Page No.- 9		
Mitutoyo Rs.	12	N	5	1540	1954	3557		2179	7160
Code				<b>186-105</b>	<b>186-106</b>	<b>186-107</b>		<b>186-110</b>	<b>186-902</b>
Catalog				Page No.- 5	Page No.- 5	Page No.- 5		Page No-5	Page No.- 5

#### 60 - 1 | Digital Radius Gauge

Range-mm	W	C	D %	5-700mm
Resolution				<b>0.01 / 0.001</b>
Insize Rs.	12	N		18107
Code				<b>2183</b>
Catalog				Page No.- 3

#### 60 - 2 | Sphere Radius Gauge

Range of Radius (Sr)	W	C	D %	15-100mm	325-1250mm
SR(mm)				<b>SR=50/H+H2</b>	<b>SR=312.5/H+H2</b>
Graduation				<b>0.01mm</b>	<b>0.01mm</b>
Insize Rs.	12	N		-	-
Code				<b>2392-100</b>	<b>2392-1250</b>
Catalog				Page No. 4	Page No. 4

**Note:- Aerospace item once sold will not be taken back even if it is Faulty.**

## **Terms & Conditions –**

- Goods offered - Subject to Prior Sale
- Price Validity: "15 Days from Date of Quotation"
- C.S.T 2% extra against form C. Otherwise 5% without form C For Out of Gujarat Sales only.
- VAT 5% extra for Sales within Gujarat. Prices Ex-Godown Ahmedabad.
- Payment against Proforma Invoice, Packing, Forwarding & Freight extra.
- **Bank Detail** – Kotak Mahindra Bank Ltd.
- **Branch** – Shivranjini
- **Bank IFSC Code** - KKBK 0000 810
- **Bank Account No.** 08102 00000 2689
- Note - While making payment online do mention your Company's name.
- TIN NO 24070901229 , CST No. 24570901229
- We are looking forward to your valued orders.

# INSIZE MAKE

## RADIUS GAGE

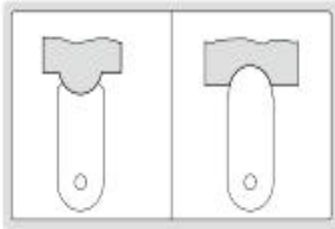

4801-17

Code	Range	Radius of leaves included (mm)	Quantity of leaves (internal + external)	Accuracy
4801-17	1 - 7mm	1, 1.25, 1.5, 1.75, 2, 2.25, 2.5, 2.75, 3, 3.5, 4, 4.5, 5, 5.5, 6, 6.5, 7	17+17	±0.03mm
4801-16	7.5 - 15mm	7.5, 8, 8.5, 9, 9.5, 10, 10.5, 11, 11.5, 12, 12.5, 13, 13.5, 14, 14.5, 15	16+16	±0.035mm
4801-15	15.5 - 25mm	15.5, 16, 16.5, 17, 17.5, 18, 18.5, 19, 19.5, 20, 21, 22, 23, 24, 25	15+15	±0.042mm

## DIGITAL RADIUS GAGE



2183

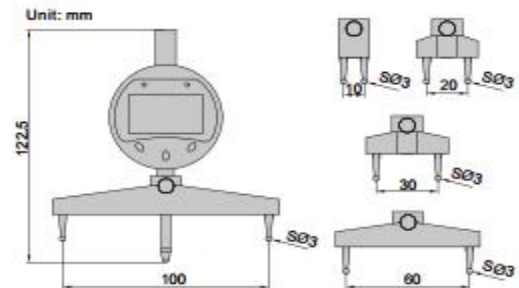

- Measure radius of internal and external arcs
- Supplied with 5 jaws for different sizes of arc
- Battery CR2032

Code	Range of radius (R)	Resolution	Accuracy (mm)
2183	5-700mm/0.2-27.5"	0.005mm/0.00005"	±0.01R*

\* R is the radius to be measured

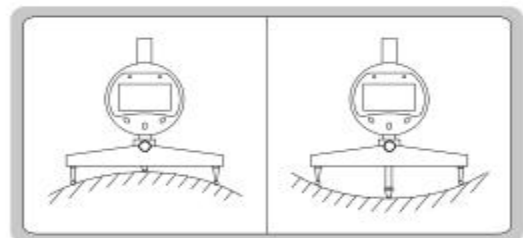

# SPHERE RADIUS GAUGE



2392-100



2392-1250

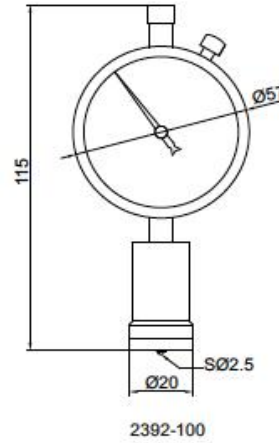

2392-100

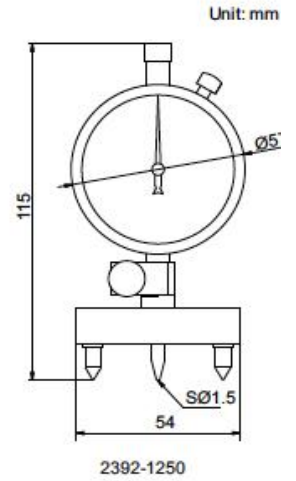

2392-1250

Unit: mm

- Measure radius of sphere

Code	Range of radius (SR)	SR(mm)	Graduation	Accuracy(mm)
2392-100	15-100mm	$SR=50/H + H/2$	0.01mm	$\pm 0.01SR(0.02SR+1.1)^*$
2392-1250	325-1250mm	$SR=312.5/H + H/2$	0.01mm	$\pm 0.01SR(0.001SR+0.7)^*$

\*SR is the radius to be measured

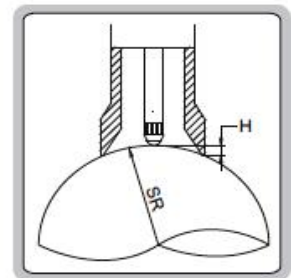

# RADIUS GAGE SET



4804-26

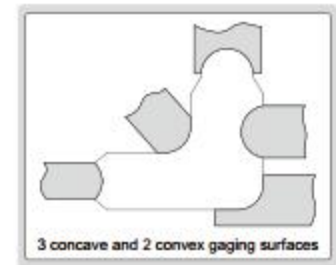

- Each piece has 3 concave and 2 convex gauging surfaces
- Supplied with handle

Code	Range	Radius of leaves included (mm)	Quantity of leaves	Accuracy
4804-26	0.5-13mm	0.5, 1, 1.5, 2, 2.5, 3, 3.5, 4, 4.5, 5, 5.5, 6, 6.5, 7, 7.5, 8, 8.5, 9, 9.5, 10, 10.5, 11, 11.5, 12, 12.5, 13	26	$\pm 0.05mm$



# MITUTOYO MAKE

## Radius Gages

### SERIES 186

#### FEATURES

- Radius size is stamped on each gage.
- Both concave and convex radius gages become a pair.
- With a locking clamp.

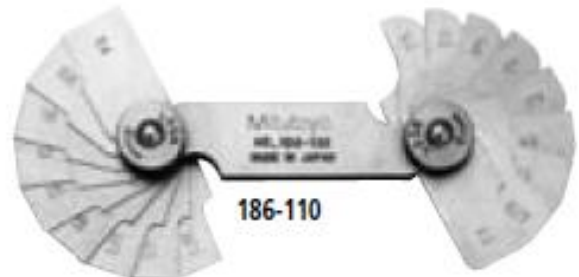

#### SPECIFICATIONS

##### Metric

Range	Order No.	Composition of leaves	Remarks
0.4 - 6mm	<b>186-110</b>	18 pairs: 0.4, 0.8, 1, 1.2, 1.5, 1.6mm, 1.75 - 3mm by 0.25mm, 3.5 - 6mm by 0.5mm	90° arc
0.5 - 13mm	<b>186-902</b>	26 pairs: 0.5 - 13mm by 0.5mm	90° arc
1 - 7mm	<b>186-105</b>	34 pairs: 1 - 3mm by 0.25mm 3.5 - 7mm by 0.5mm	180° arc
7.5 - 15mm	<b>186-106</b>	32 pairs: 7.5 - 15mm by 0.5mm	180° arc
15.5 - 25mm	<b>186-107</b>	30 pairs: 15.5 - 20mm by 0.5mm, 21 - 25mm by 1mm	180° arc

##### Inch

Range	Order No.	Composition of leaves	Remarks
1/32" - 17/64"	<b>186-103</b>	16 pairs: 1/32" - 17/64" by 64ths	90° arc
1/32" - 1/4"	<b>186-101</b>	15 pairs: 1/32" - 1/4" by 64ths	180° arc
17/64" - 1/2"	<b>186-102</b>	16 pairs: 17/64" - 1/2" by 64ths	180° arc
9/32" - 33/64"	<b>186-104</b>	16 pairs: 9/32" - 33/64" by 64ths	90° arc
1/64" - 1/2"	<b>186-901*</b>	25 pairs: 1/64" - 17/64" by 64ths, 9/32" - 1/2" by 32nds	—

\*Each gage has five measuring locations.

# KRISTEEL MAKE

## Radius Gauge



	No. of blades	Radius,mm	Leads,mm
A	17	1-7	1-3=0.25, 3-7=0.5
B	16	7.5-15	7.5-15=0.5
C	16	15.5-25	15.5-25=0.5

Concave and convex blades. With nickel plated case and locking screw. For the checking of sectors of circle.

## RADIUS GAUGES

KRISTEEL® - Shinwa

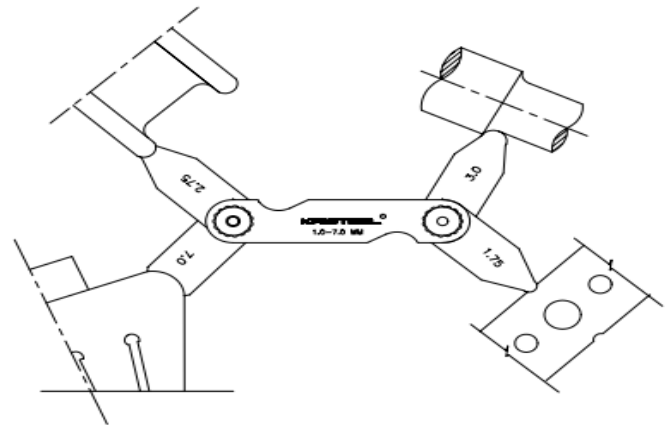
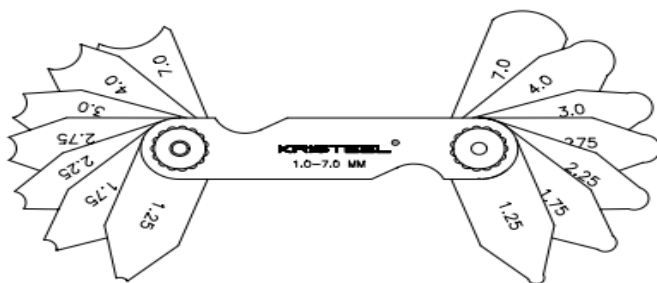

MATERIAL :- Stainless Steel  
 RANGE :- 1-7 , 7.5-15 , 15.5-25 mm.  
 INCRIMENTAL OF 0.5 mm.  
 FINISH :- POLISHED BY TUMBLING

USES :- To check the Radius of Concave and Convex of any Radial part.  
 Gauge made of stainless steel with fine blanking .  
 Usefull in Workshop General porpose , Tool & Die maker , Wood working Industries , Quality Dept. etc.  
 Gauge is packed in pvc pouch .

AVAILABLE MODELS :-

1) 1.0 to 7.0 mm	4) 9/32" to 33/64"
2) 7.5 to 15.0 mm.	5) 17/64" to 1/2"
3) 15.5 to 25.0 mm.	6) 1/32" to 1/4"

# RADIUS GAUGES

KRISTEEL® - Shinwa

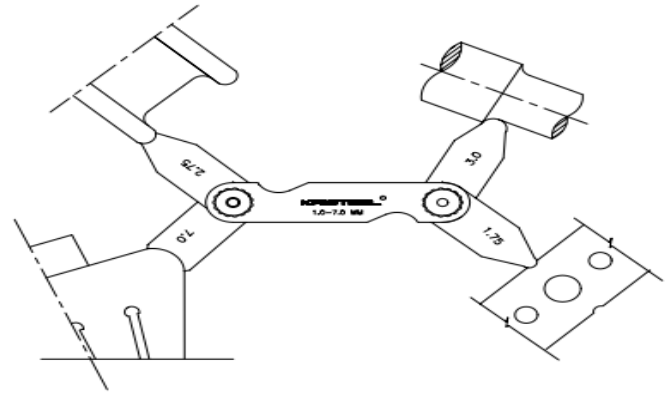
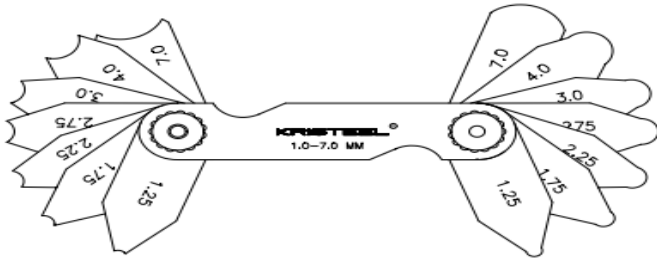

**MATERIAL :-** Stainless Steel

**RANGE :-** 1-7 , 7.5-15 , 15.5-25 mm.

**INCREMENTAL OF 0.5 mm.**

**FINISH :-** POLISHED BY TUMBLING

**USES :-** To check the Radius of Concave and Convex of any Radial part.

Gauge made of stainless steel with fine blanking .

Usefull in Workshop General porpose , Tool & Die maker , Wood working Industrles , Quality Dept. etc.

Gauge is packed in pvc pouch .

**AVAILABLE MODELS :-**

1) 1.0 to 7.0 mm

4) 9/32" to 33/64"

2) 7.5 to 15.0 mm.

5) 17/64" to 1/2"

3) 15.5 to 25.0 mm.

6) 1/32" to 1/4"

# RADIUS GAUGE 25- 40 mm

KRISTEEL® - Shinwa

**MATERIAL :-** Stainless Steel

**RANGE :-** 25 to 40 mm. ( 32 Leaves )

**INCREMENTAL OF 0.5 mm.**

**FINISH :-** POLISHED

**USES :-** To check the Radius of Concave and Convex of any Radial part.

Gauge made of stainless steel with fine blanking

Usefull in Workshop General porpose , Tool & Die maker , Wood working Industrles , Quality Dept. etc.

All Gauge Leaves are assembled in metal Ring to easy accessing.

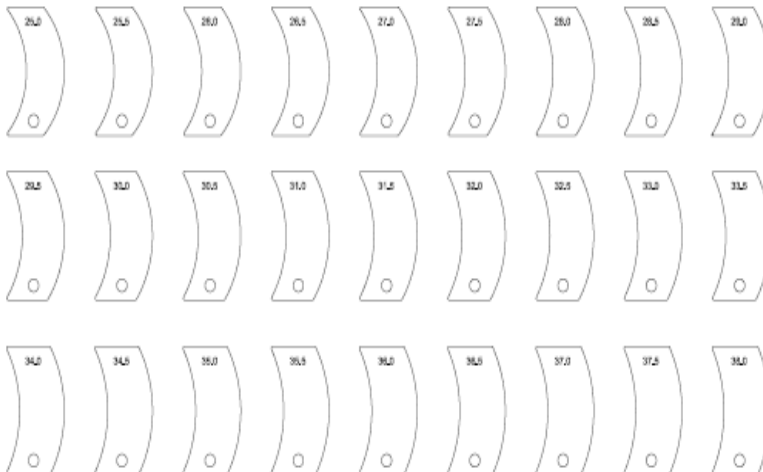

## RADIUS GAUGE 26 PC SET - 0.5 mm TO 13 mm (MODEL 1512-26 L)



### RADIUS GAUGE 26PC SET

This set is mainly used to check the radius of concave and convex portion of any radial part. This gauge is useful in workshops, general purpose, tool and die makers, woodworking industries, quality department etc. The gauge is packed in PVC pouch with brass handle to hold the leaf while checking. The accuracy of the product is equivalent to international standards.

Range: 0.5 mm to 13 mm- 26 leaves. (Incremental of 0.5 mm)

## RADIUS GAUGE SET OF 26 LEAVES

**KRISTEEL® - Shinwa**

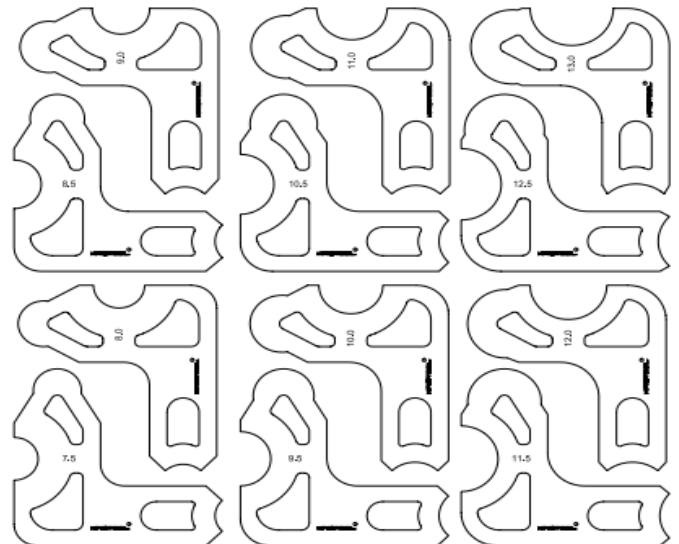
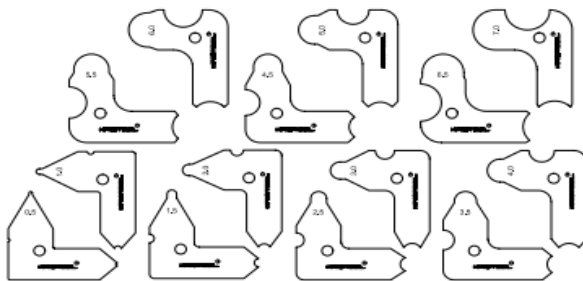

**MATERIAL** :- Stainless Steel  
**RANGE** :- 0.5 to 13.0 mm. ( 26 leaves )  
          INCRIMENTAL OF 0.5 mm.  
**FINISH** :- POLISHED BY TUMBLING

**USES** :- To check the Radius of Concave and Convex of any Radial part.

Gauge made of stainless steel with edm wire cutting and fine blanking

Usefull in Workshop General porpose , Tool & Die maker , Wood working Industries , Quality Dept. etc.

Gauge is packed in pvc pouch with brass Handle to hold the gauge leaf while checking.



# MGW MAKE

## Radius gauge Set



CODE	RANGE	PRICE
RGS 13	0.5 -13 mm	1,800/-
RG 7	1 -7 mm	350/-



RGS 13

CODE	RANGE	PRICE
RG 15	7.5 -15 mm	450/-
RG 25	15.5 -25 mm	550/-