



BEARING & TOOL CENTRE



Head Office

1st Floor, Vyapar Bhavan, Kadia Kui,
Relief Road, Ahmedabad - 380001.
Ph:- 079 - 22160386, 65254835, 22134835
Mobile : 7819819941, 9375706649

Ahmedabad Branch

GF-B-14, Jayraj Complex, Nr. Soni ni Chawl,
Odhav, Ahmedabad - 382415.
Ph:- 079 - 22890202, 65458950, 65404657, 65400202
Mobile : 7878825197, 7819819938, 9375706648

Website : www.bearingtoolcentre.com, www.bearingtoolscentre.com | Email : info@bearingtoolcentre.com

Our Sister Concern : RELIEF SERVICE CENTRE

Repairs, Removal of Jaw Error, Bore Gauge Extension, Instrument Modifications & Spares

Quotation

156 | Screw Jack – Milhard Make

Model	Rs.	Size	Catalog
SJ – 1	1740	55 x 80mm	Page No. - 3
SJ – 2	2320	80 x 105mm	Page No. - 3

156 – 1 | Leveling Screw Jack – CI (With Standard Pad) – Black Hawk Make

Model	D %	Rs.	Range (mm)	Catalog
A – 246	18	494	80 – 90	Page No. - 4
A - 247	18	604	95 – 120	Page No. – 4
A - 248	18	968	100 – 135	Page No. – 4

156 – 2 | Leveling Screw Jack – Steel Body (With out Pad) – Black Hawk Make

Model	D %	Rs.	Range (mm)	Catalog
A – 251	18	266	40 – 50	Page No. - 4
A - 252	18	459	50 – 70	Page No. – 4
A - 253	18	640	70 – 100	Page No. – 4
A - 254	18	1449	100 – 140	Page No. - 4
A - 255	18	2027	140 – 210	Page No. – 4
A - 256	18	4107	190 – 300	Page No. – 4

156 – 3 | Leveling Screw Jack – Pad – Black Hawk Make

Model	D %	Rs.	Range (mm)	Catalog
A – 261	18	97	28 x 17	Page No. - 4
A – 262	18	97	28 x 17	Page No. – 4
A – 263	18	97	32 x 6	Page No. – 4
A – 264	18	117	28 x 22.5	Page No. - 4
A – 265	18	117	32 x 24	Page No. – 4
A – 266	18	147	28 x 15 (Dome Ø 15r)	Page No. – 4
A – 267	18	147	32 x 17 (Dome Ø 15r)	Page No. – 4
A – 268	18	147	28 x 20 (‘V’ angle 90°)	Page No. – 4

Sr No.	Cat No.	Size (mm)	Range (mm)	Catalog	Price
1	UL - 30401	40	50 - 70	Page No. – 6	445
2	UL - 30402	50	100 - 150	Page No. – 6	575
3	UL - 30403	60	150 - 250	Page No. – 6	945
4	UL - 30404 A	Pad 25	-----	Page No. – 6	120
5	UL - 30404 B	Pad 25	-----	Page No. – 6	120
6	UL - 30404 C	Pad 25	-----	Page No. – 6	120
7	UL - 30404 D	Pad 25	-----	Page No. – 6	120
8	UL - 30404 E	Pad 25	-----	Page No. – 6	120
9	UL - 30404 F	Pad 60		Page No. – 6	120
10	UL - 30405 SET	(1+1)Pair jack - 40 & 50 + Pad A to F-1no. each		Page No. – 6	2780
11	UL - 30406 SET	(1+1)Pair jack - 50 & 60 + Pad A to F-1no. each		Page No. – 6	3600

NABL Calibration For any New Instrument Purchase from us @ Rs. 200/- . Except for Item In set (E.g. Feeler / Slip Gauge Etc)

Terms & Conditions –

- ✚ Goods offered - Subject to Prior Sale
- ✚ Price Validity: "15 Days from Date of Quotation"
- ✚ C.S.T 2% extra against form C. Otherwise 5% without form C For Out of Gujarat Sales only.
- ✚ VAT 5% extra for Sales within Gujarat. Prices Ex-Godown Ahmedabad.
- ✚ Payment against Proforma Invoice, Packing, Forwarding & Freight extra.
- ✚ **Bank Detail** – Kotak Mahindra Bank Ltd.
- ✚ **Branch** – Shivranjini
- ✚ **Bank IFSC Code** - KKBK 0000 810
- ✚ **Bank Account No.** 08102 00000 2689
- ✚ Note - While making payment online do mention your Company's name.
- ✚ TIN NO 24070901229 , CST No. 24570901229
- ✚ We are looking forward to your valued orders.
- ✚ .

MILHARD MAKE

SCREW JACKS



- Used for the accurate levelling of surface plates, machines and other precision instruments
- Supplied in set of 3 pieces with 1 handle

Model	Nominal Height (mm)	Max Height (mm)	Load Bearing Capacity	Net Weight (Kgs.)
SJ-1	55	80	400 Kgs	1.23
SJ-2	80	105	400 Kgs	2.60

Series-SJ

Black Hawk Make



Leveling Screw Jack-Pad



Leveling Screw Jack-CI



Leveling Screw Jack-Steel Body

LEVELING SCREW JACK - CI (With Standard Pad)



Range mm	Code	Price Per Unit
80 - 90	A 246	494,00
95 - 120	A 247	604,00
100 - 135	A 248	968,00

LEVELING SCREW JACK - STEEL BODY

(Without Pad)



Range mm	Kn	Code	Price Per Unit
40 - 50	12	A 251	266,00
50 - 70	60	A 252	459,00
70 - 100	60	A 253	640,00
100 - 140	100	A 254	1449,00
140 - 210	165	A 255	2027,00
190 - 300	350	A 256	4107,00

LEVELING SCREW JACK - PAD

Size mm	Code	Price Per Unit
28 x 17	A 261	97.00
28 x 17	A 262	97.00
32 x 6	A 263	97.00
28 x 22.5	A 264	117.00
32 x 24	A 265	117.00
28 x 15 (Dome Ø 15r)	A 266	147.00
32 x 17 (Dome Ø 15r)	A 267	147.00
28 x 20 ('V' angle 90°)	A 268	147.00

...: LEVELING SCREW JACKS ...



Features:

- Used for supporting the job
- Safe reliable adjustment of height
- Made from good quality graded cast-iron / alloy steel material
- Lock nut for the adjustment
- Can be used with different pads

Cast Iron Screw Jack (With Standard Pad)

Model No.	Range (h-h ₁)	Dia - (D)	Load (Kn)	Weight (Kg)
A 246	90-115	60	7.5	0.600
A 247	120-140	65	10	1.150
A 248	125-155	100	12	2.220

All measurements in mm

Steel Screw Jack (Without Pad)

Model No.	Range (h-h ₁)	Dia - (D)	Load (Kn)	Weight (Kg)
A 251	40 - 50	32	12	0.210
A 252	50 - 70	36	60	0.300
A 253	70 - 100	50	60	0.980
A 254	100 - 140	80	100	3.450
A 255	140 - 210	80	165	5.100
A 256	190 - 300	100	350	10.500

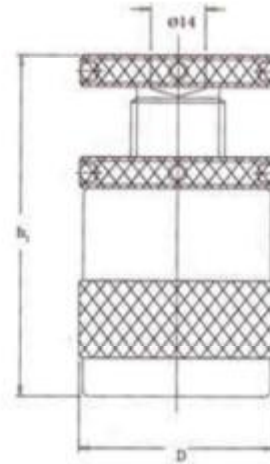
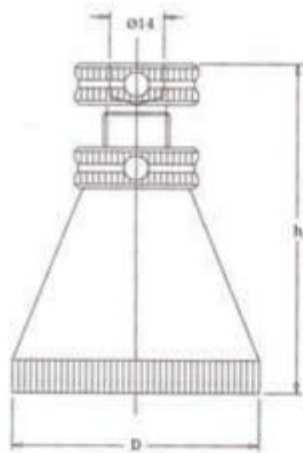

Screw jack can be used for the accurate leveling of surface plates, machines and other precision instruments. The adjustment screw of movable head can adjust the appropriate precision for the screw jack at any time.

ULTRA MAKE

SERIES UL- 304 "ULTRA" SUPPORT SCREW JACK



UL - 30401	Ø 40	445 Each
UL - 30402	Ø 50	575 Each
UL - 30403	Ø 60	945 Each
UL -30405 Set	(1+1) Pair Jack- Ø 40 & Ø 50 + Pad A to F - 1 no. each	2780 Set
UL -30406 Set	(1+1) Pair Jack- Ø 50 & Ø 60 + Pad A to F - 1 no. each	3600 Set

UL - 30404 A	Pad Ø 25	120 Each
UL - 30404 B	Pad Ø 25	120 Each
UL - 30404 C	Pad Ø 25	120 Each

UL -30404 D	Pad Ø 25	120 Each
UL -30404 E	Pad Ø 25	120 Each
UL -30404 F	Pad Ø 25	120 Each
UL- 30404 G	Pad Ø 60	230 Each